

IP Signalling

Issue Date: 07/08/2019 contact: sam.purcell@networkrail.co.uk

Issue Number: IPSIG-SL010 Title: Operational Close Call – Streatham Common station

Overview of Event:

The SWL/COSS arrived at Streatham Common station car park and contacted the Signaller to discuss the line block arrangements to access an area for FTN Node survey within a REB on the BTH1 line.

During the conversation between a Signaller and a COSS/SWL to arrange a line blockage it became apparent, due to the vigilance of the signaller, that the COSS was potentially going to access at the wrong location meaning the team would not have adequate protection in place.

The planned line block covered access from **Streatham** along the **BTH1** line between TVSC778 and TVSC788.

The COSS was potentially going to access from **Streatham Common** which is on the **VTB1** line, with the planned line blocks between TVSC778 and TVSC788 signals on the Up Portsmouth line. The operative stated that he was speaking from Streatham Common station (VTB1 line) and identified the location of the worksite. The Signaller challenged the COSS/SWL regarding the worksite location for access and cancelled the proposed line blockage.

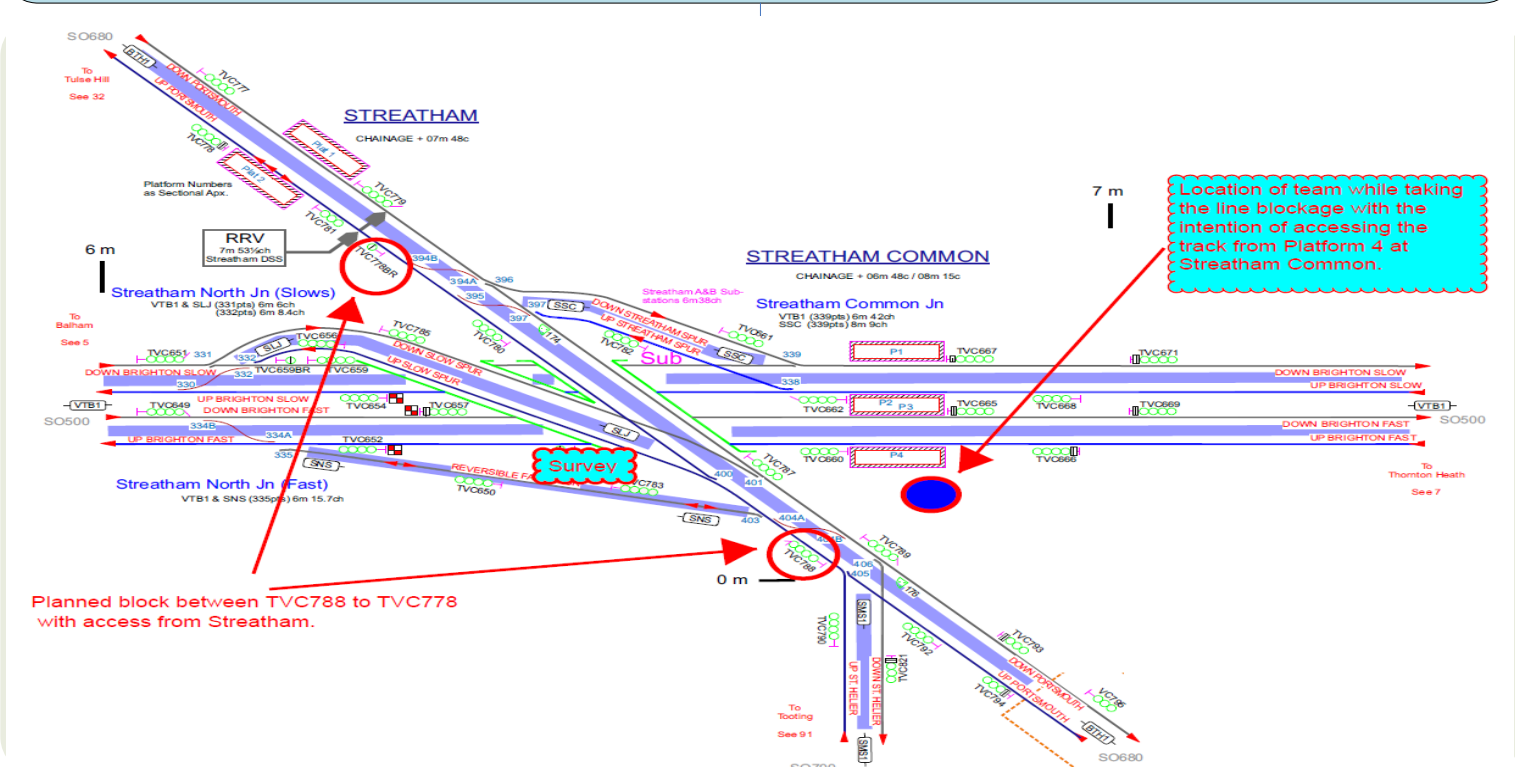

Discussion Points:

- Are Safe Work Packs comprehensively reviewed and authorised by the Responsible Manager before being issued?
- Are Safe Work Packs reviewed prepared and by the COSS/SWL prior to the start of work and on arrival at the access point?
- Do we allow ourselves to become complacent when working in familiar locations?
- Could we use technology to check our location?
- Do we regularly challenge and question current processes?